

**STRATFORD
EAST**

HIRE US

Theatre Royal Stratford East
& Stratford Youth Zone

For more information please visit
stratfordeast.com/hire



GETTING HERE

Theatre Royal Stratford East and Stratford Youth Zone are situated next door to each other. Stratford is located in Zone 2 with excellent transport links, making it easy to reach wherever you are travelling from.

Onsite parking is extremely limited and may not be available. Please contact us to discuss parking and/or deliveries.

We're just a few minutes from Stratford Tube, DLR, National Rail and Bus Stations. There is no parking at Stratford East but we are situated next to the large pay & display multi-storey car park above the Stratford Centre.



**THEATRE ROYAL
STRATFORD EAST**
Gerry Raffles Square
Stratford
London
E15 1BN



**STRATFORD
YOUTH ZONE**
Theatre Square
Stratford
London
E15 1BX

BY CAR

Stratford East is easily accessible by road:

- from the West via the Bow Flyover
- from South via the Blackwall Tunnel or the Rotherhithe Tunnel
- from the North via the North Circular
- from the East via the A12

We are situated next to a large pay & display multi-storey car park, with several other car parks nearby.

BY TRAIN

Stratford Station is served by National Rail, London Overground, Docklands Light Railway, and London Underground Central and Jubilee lines.

 **Central Line** 20 minutes from the West End.

 **Jubilee Line** 20 minutes from Waterloo.

 **National Rail** 8 minutes from Liverpool Street.

 **Overground** 15 minutes from Highbury & Islington



THEATRE ROYAL STRATFORD EAST

AUDITORIUM

SPACE DIMENSIONS

- Proscenium width: 69.2m
- Proscenium height: 64.5m
- Depth of stage: 115.7m
- Fock doors: 21m wide x 50m high
- Raked Stage: 1:20
- Depth to "second proscenium": 51.4m
- Height to grid: 11.9mm upstage/12.4m Downstage

ABOUT THE SPACE

- Main space entrance on ground floor, audience seating covers 3 levels
- For seated performances, only the ground floor is wheelchair accessible
- Access to a loading bay and parking (delivery vehicles only)
- The auditorium cannot be hired for professional theatre performances. If you are interested in staging a production, please contact theatreroyal@stratfordeast.com

CAPACITY

Theatre Set-up: Up to 469 people

BASIC TECH AVAILABLE IN THE SPACE

- Built in PA system
- Theatrical lighting rig
- Follow spots
- Raked stage

STAFF

- A Duty Technician is included in the price of the hire
- Events with an audience will require front of house staff dependent on audience size and length of event (from £400)

GUIDE HIRE RATE

	½ Day Rate (4hrs)	Full Day rate (8hrs)
Mon – Sat	£1000	£1800
Sun	£2040	£3541.50

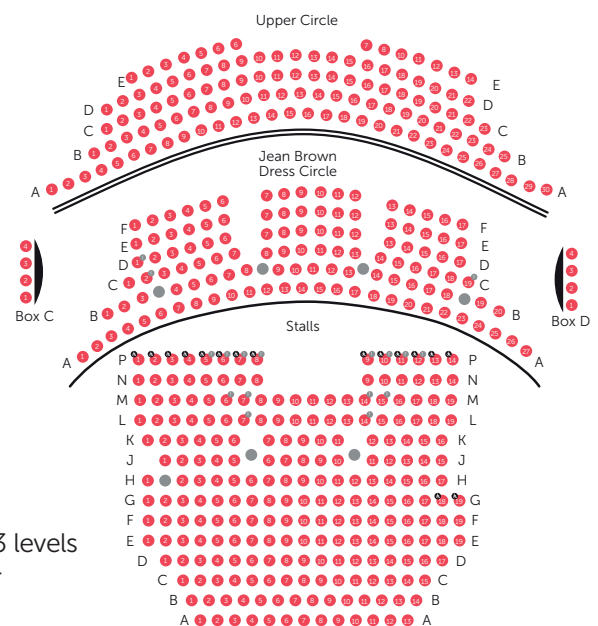

STAGE





STRATFORD YOUTH ZONE AUDITORIUM

SPACE DIMENSIONS

- 15.2m x 24.9m (clear space including stage)
- 15.2m x 12.4m (clear space excluding stage)

ABOUT THE SPACE

- Main space entrance on ground floor
- Audience seating over three levels
- All levels are wheelchair accessible
- Access to a loading bay and parking (delivery vehicles only)

CAPACITIES

Cabaret Set-up 120 people

Theatre Set-up 256 people

Standing Event 500 people

BASIC TECH AVAILABLE IN THE SPACE

- Freestanding PA system available
- No theatrical lighting or sound systems available in this space

No other technical facilities are currently available in this space; please speak with a member of the Hires team for further information.

STAFF

- Events with an audience will require front of house staff dependent on audience size and length of event (from £250)

GUIDE HIRE RATE

	½ Day Rate (4hrs)	Full Day rate (8hrs)
Mon – Sat	£450	£800
Sun	£1132	£1931

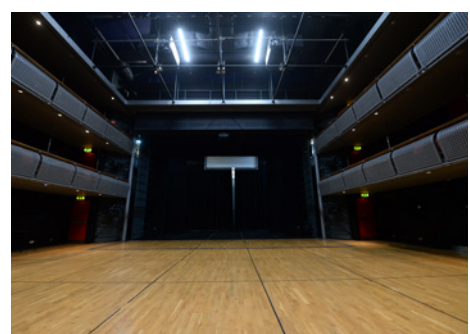



STRATFORD YOUTH ZONE STUDIO THEATRE

SPACE DIMENSIONS

- 10.3m x 6.8m (With seating)
- 10.3m x 10.8 (Without seating)

ABOUT THE SPACE

- Located on ground floor
- Access to a loading bay and parking (delivery vehicles only)

CAPACITIES

Cabaret Set-up	70 people
Theatre Set-up	93 people
Standing Event	150 people

BASIC TECH AVAILABLE IN THE SPACE

- Built in PA system

BASIC FURNITURE AVAILABLE

- 20 freestanding chairs
- 93 retractable raked bleacher seats

STAFF

- A Duty Technician is included in the price of the hire
- Events with an audience will require front of house staff dependent on audience size and length of event (from £200)

GUIDE HIRE RATE

	½ Day Rate (4hrs)	Full Day rate (8hrs)
Mon – Sat	£500	£900
Sun	£1120	£1772





STRATFORD YOUTH ZONE DANCE STUDIO

SPACE DIMENSIONS

15m x 14m (approx.)

ABOUT THE SPACE

- Located on 2nd Floor
- Lift Accessible
- Mirrored wall
- Ballet barre along wall
- Sprung floor

CAPACITIES

Cabaret Set-up 60 people
Theatre Set-up 70 people
Standing Event 200 people

BASIC TECH AVAILABLE IN THE SPACE

Free standing PA Stack

BASIC FURNITURE AVAILABLE

20 Chairs

GUIDE HIRE RATE

	½ Day Rate (4hrs)	Full Day rate (8hrs)
Mon – Sat	£350	£650
Sun	£1157	£1831





THEATRE ROYAL STRATFORD EAST

HEDLEY REHEARSAL ROOM

SPACE DIMENSIONS

8m x 8m

ABOUT THE SPACE

- 2nd Floor
- Lift accessible

CAPACITIES

Seated Set-up 65 people
Standing Event 100 people

BASIC TECH AVAILABLE IN THE SPACE

PA Stack

GUIDE HIRE RATE

	½ Day Rate (4hrs)	Full Day rate (8hrs)
Mon – Sat	£200	£350
Sun	£657	£1081





STRATFORD YOUTH ZONE CONFERENCE ROOM

SPACE DIMENSIONS

4m x 5m (approx.)

ABOUT THE SPACE

- Located on 2nd floor
- Lift Accessible

CAPACITIES

Board Room Set-up 20 people
Standing Event 40 people

BASIC TECH AVAILABLE IN THE SPACE

Digital Screen

BASIC FURNITURE AVAILABLE

- Large Board table
- 12 Chairs

GUIDE HIRE RATE

	½ Day Rate (4hrs)	Full Day rate (8hrs)
Mon – Sat	£150	£250
Sun	£607	£981





THEATRE ROYAL STRATFORD EAST

DILLON ROOM

SPACE DIMENSIONS

8m x 4m

ABOUT THE SPACE

- Ground Floor
- Separate building entrance
- Dedicated private bathroom

CAPACITIES

Seated Set-up 25 people
Standing Event 60 people

BASIC TECH AVAILABLE IN THE SPACE

PA Stack

GUIDE HIRE RATE

	½ Day Rate (4hrs)	Full Day rate (8hrs)
Mon – Sat	£150	£250
Sun	£607	£981





THEATRE ROYAL STRATFORD EAST

MURRAY MELVIN ROOM

SPACE DIMENSIONS

6.95m x 4.20m

ABOUT THE SPACE

- Located on 2nd Floor
- Lift Accessible

CAPACITIES

Board Room Set-up 40 people
Seated Set-up 20 people
Standing Event 30 people

BASIC FURNITURE AVAILABLE

20 chairs

GUIDE HIRE RATE

	½ Day Rate (4hrs)	Full Day rate (8hrs)
Mon – Sat	£150	£250
Sun	£607	£981





THEATRE ROYAL STRATFORD EAST

KEN HILL BAR

SPACE DIMENSIONS

4m x 4.5m

ABOUT THE SPACE

- 1st floor
- Lift Accessible

CAPACITIES

Seated Set-up 25 people
Standing Event 60 people

GUIDE HIRE RATE

	½ Day Rate (4hrs)	Full Day rate (8hrs)
Mon – Sat	£120	£200
Sun	£577	£931





STRATFORD YOUTH ZONE

GROUND FLOOR FOYER & FIRST FLOOR MEZZANINE

SPACE DIMENSIONS

Ground floor central space 13m x 13m approx.

ABOUT THE SPACE

- These spaces are only available for hire as ancillary spaces alongside other room hire
- First floor is lift accessible
- Both areas have independent bar areas

CAPACITIES

Standing Event 80 people

BASIC TECH AVAILABLE IN THE SPACE

- Built in PA Stack
- Coloured LED lights

GUIDE HIRE RATE

	½ Day Rate (4hrs)	Full Day rate (8hrs)
Mon – Sat	£120	£200
Sun	£577	£931

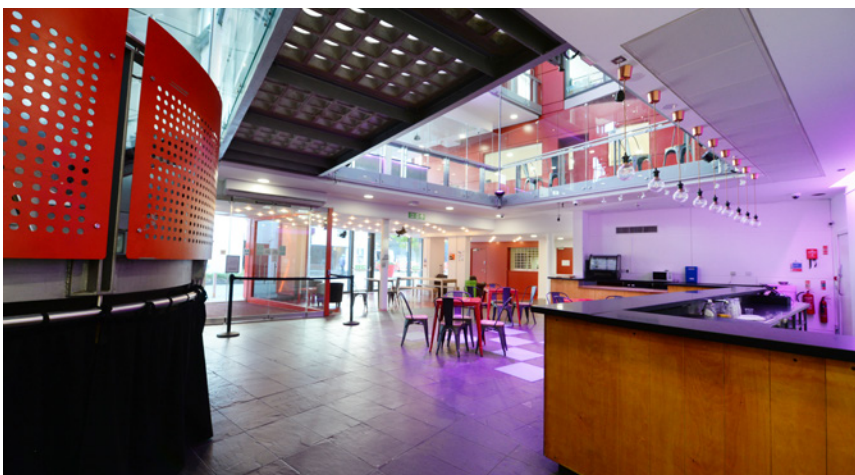

EXTRAS

We know that you might need additional support and equipment to complete your hire. Please let us know your needs, and we will do our best to accommodate them.

We can provide the following free of charge (subject to availability):

- Flip Chart and Stand
- Additional Chairs
- PA Stack

We can also provide the following for an additional cost:

- Additional furniture
- Technical Equipment
- Staffing
- Catering
- Photocopying
- Box office services

Please talk to us about any extras you need, and we will do our best to help.

RATES

All charges are exclusive of VAT

	Monday – Saturday		Sunday	
	½ Day (4hrs)	Full Day (8hrs)	½ Day (4hrs)	Full Day (8hrs)
TRSE Auditorium	£1000	£1800	£2040	£3541.50
SYZ Auditorium	£450	£800	£1132	£1931
SYZ Studio Theatre	£350	£600	£982	£1631
Dance Studio	£120	£200	£577	£931
Hedley	£120	£200	£577	£931
Conference Room	£150	£250	£607	£981
Dillon	£350	£650	£1157	£1831
Murray Melvin	£150	£250	£607	£981
Ken Hill Bar	£150	£250	£607	£981
SYZ Mezzanine	£200	£350	£657	£1081
SYZ Foyer	£120	£200	£577	£931

N.B. Community and charitable rates are available on application

- Balance must be paid 14 days in advance of hire
- A deposit of 50% of hire cost must be paid to secure the booking
- Cancellation fees:
 - 28 days or more before event: Full refund
 - 14-28 days before event: 50% of full hire fee plus any non-redeemable costs incurred
 - Less than 14 days before event: Non-refundable

OPENING TIMES

Opening our building out of standard operating hours requires additional support from our Operations Team. If your event requires additional hours, please ask for a quote.

DAY	TRSE	SYZ
MONDAY	10am-10pm	9am-10pm
TUESDAY	10am-10pm	9am-10pm
WEDNESDAY	10am-10pm	9am-10pm
THURSDAY	10am-10pm	9am-10pm
FRIDAY	10am-10pm	9am-10pm
SATURDAY	10am-10pm	9am-6pm
SUNDAY	By Appointment Only	By Appointment Only